



XGT - 40V MAX LI-ION SERIES

**XGT**

**40V** *Li-ion*  
**max**



# XGT

**XGT is a new system with its own tools, batteries, and chargers. A combination of innovative tool design and higher output batteries provides a genuine solution for high demand industrial users**

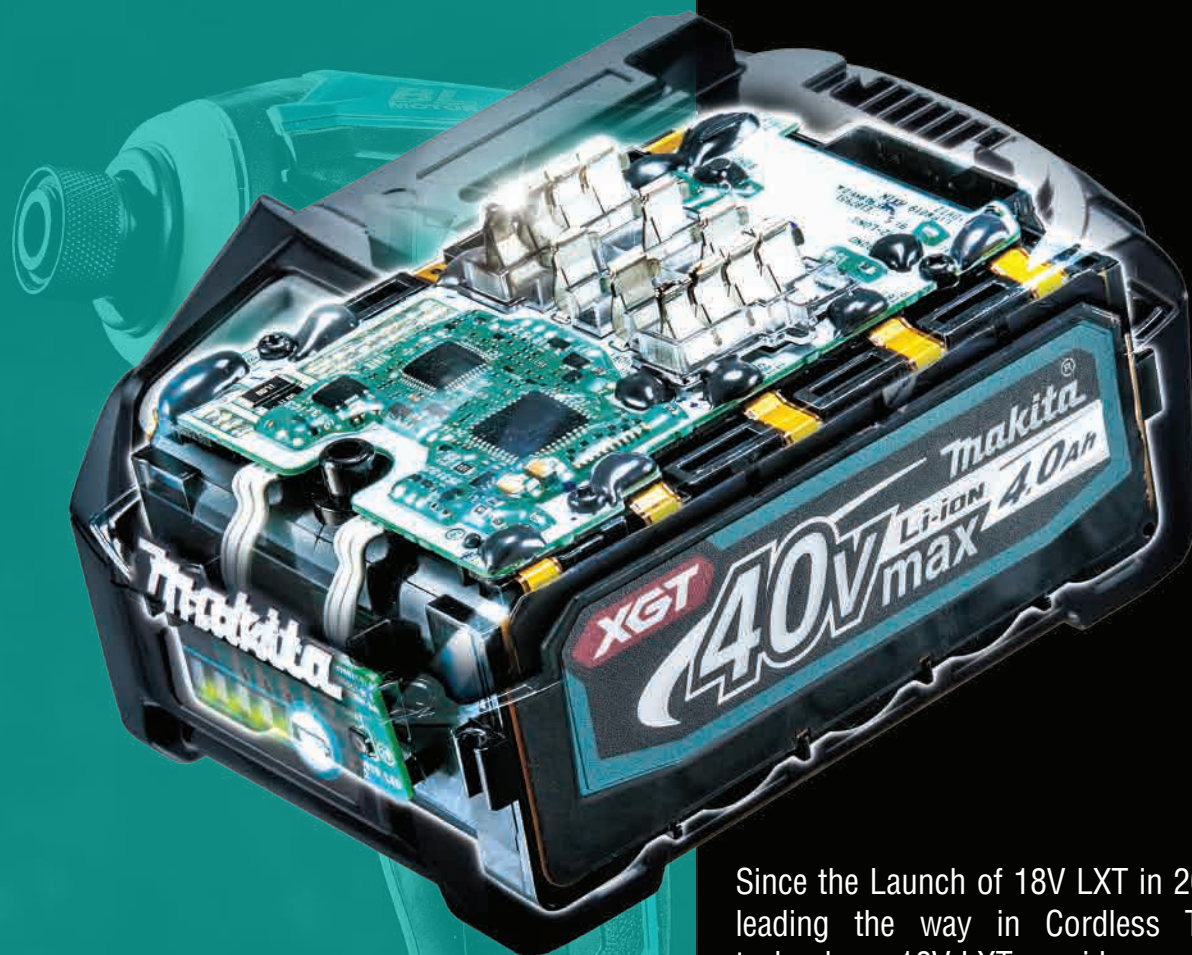

Since the Launch of 18V LXT in 2005, Makita has been leading the way in Cordless Tool innovation and technology. 18V LXT provides consumers with not only the largest range on one battery, it also provides consumers with the most reliable and efficient tools available.

Our vision as a Company is to provide consumers with a battery solution for all applications across Building Construction, Industrial, Outdoor Power Equipment and Commercial Cleaning Channels. In keeping with our vision.

Makita is ready to lead the way once again in 2020, we are excited to announce the launch of our new XGT 40V battery system that will coexist with LXT and continue towards our vision of a battery solution for all applications!



# INDEX

**05 — 40V MAX LI-ION BATTERY & CHARGER**

**06 — DRIVER DRILL**  
DF001G

**07 — PERCUSSION DRIVER DRILL**  
HP001G

**08 — IMPACT DRIVER**  
TD001G

**09 — IMPACT WRENCH**  
TW001G

**10 — COMBINATION HAMMERS**  
HR002G  
HR003G

**12 — ANGLE GRINDERS**  
GA004G / GA005G  
GA012G / GA013G

**14 — CIRCULAR SAW**  
HS004G

**15 — RECIPROCATING SAW**  
JR001G



## BUILT TOUGH

The batteries have durable rails which hold them securely in place when using the new high power products.

The batteries have waterproof triple-layer structure, heavy-duty outer casing and cell holder for better shock resistance.

A 4-LED fuel gauge indicator is located in the front of the battery making it easy to know when it need to be charged.



A charging adapter accessory enables the charging of both LXT and XGT products



## SMART TECHNOLOGY

The XGT range of tools and batteries come with a built-in program, that provides digital communication between the battery and the tool. The battery technology and the tools' motor engineering work together for optimum performance.



Terminal short-circuit prevention structure. The protection wall is provided between terminals against water and dust.



## FAST CHARGING

The tough 40V Max design is supported by a charging system that charges batteries in as little as 28 minutes.



## FUTURE PROOF

XGT and LXT will co-exist to provide users with an unmatched line-up of cordless tools for professional trade applications all the way up the high demand Industrial applications.

# XGT - Battery and Charger

**XGT**  
**40V<sup>Li-ion</sup> max**

**Fast Charging**



**DC40RA**

220-240 ~ 2 PIN Part #: 191E13-3

220-240 ~ 3 PIN Part #: 191E14-1

**4.0  
Ah**



**BL4040**

Part #: 191B26-6

**45min.**

# XGT - Power Source Kit - PSKG1

Part no	SET CONTENTS									
	BATTERY					CHARGER				MAKPAC CASE
	MODEL	VOLTS	AMPERE	FUEL GAUGE	QTY	MODEL	PORT	PIN	QTY	
<b>191K03-2</b>	<b>BL4040</b>	40V max	<b>4.0Ah</b>	✓	<b>2pcs</b>	<b>DC40RA</b>	<b>1</b>	<b>3</b>	<b>1pc</b>	<b>Type 1</b>



# Adapter - ADP10

The introduction of a charging adapter has enabled consumers to charge both **LXT** and **XGT** batteries when using the XGT charger



**DC40RA**  
Part #: 191E14-1

**ADP10**  
Part #: 191C11-5

Compatible  
with 18V LXT  
Li-ion batteries

**6.0  
5.0  
Ah**



**BL1860B  
BL1850B**

**40min.**

**3.0  
Ah**



**BL1830B**

**22min.**

# DF001G

## XGT - Cordless 13mm Driver Drill



**Excellent performance in continuous heavy duty applications**

Delivers **140Nm** of Max torque achieved with combination of high power brushless motor and innovative XGT battery

**New electronic clutch settings**

**A higher range of torque can be covered than with mechanical clutch**

- 41-stage setting in gear one
- 21-stage setting in gear two

Digital display

Easy jog dial adjustment of fastening torque

XGT: Electronic Clutch  
LXT: Mechanical Clutch

**Active Feedback sensing Technology**

Active Feedback Sensing Technology (AFT) that turns off the motor if the rotation speed suddenly slows down.

**AFT**

**Compact overall length**

For easy handling and control

181 mm

18V LXT  
DDF481 - (205mm)

# Efficient, Durable, Compact, Lightweight and Outstanding Performance Driver Drill

A powerful, brushless Driver Drill for screwdriving and drilling with two different power settings for professional use. A high maximum torque of 140 / 68 Nm. An ideal choice for jobs that require high power and torque. Integrated LED light. A combination of innovative tool design and higher output batteries providing a durable solution for the professional user with high demand



**Work Amount** (on a full battery charge)

Model	Battery	144pcs	768pcs
XGT	40v max (4.0Ah)	144pcs	768pcs
LXT	18V LXT (5.0Ah)	78pcs	436pcs

DDF481

Drilled holes through a 38mm SPF plate with ø2-9/16" Self-feed bit in low speed mode.

Drilled holes through a 38mm SPF plate with ø7/8" Auger bit in high speed mode.

Specification	
Capacity	Steel: 20 mm
	Wood (Auger-Bit): 50 mm
	Wood (Self-Feed Bit): 76 mm
	Wood (Hole Saw): 152 mm
Chuck Capacity	1.5 - 13 mm
No Load Speed (RPM)	High / Low: 0 - 2,600 / 0 - 650
Max Fastening Torque	Hard / Soft: 140 / 68 N·m
Max lock torque	125 Nm
Sound Pressure Level	75 dB(A)
Dimensions (L x W x H)	181x86x282 mm
Net weight	3.0 kg

Available Variants				
TYPE	VARIANTS	BATTERIES	CHARGER	MAKPAC CASE
W/O Battery / Charger	DF001G Z	-	-	-
With Battery / Charger	DF001G M2	BL4040 (4.0Ah) 2pcs	DC40RA 1pc	Type 3

# HP001G

## XGT - Cordless 13mm Percussion Driver Drill

**40V<sub>max</sub> BL AFT XPT**

Impact Mode selection ring

Mechanical 2-speed

LED job light

Ergonomic designed body

Long rigid side grip helps to stabilize the bit for steady drilling/screwdriving

**Excellent performance in continuous heavy duty applications**

Delivers **140Nm** of Max torque achieved with combination of high power brushless motor and innovative XGT battery

**Electronic clutch settings**

A higher range of torque can be covered than with mechanical clutch

- 41-stage setting in gear one
- 21-stage setting in gear two

Digital display

Easy jog dial adjustment of fastening torque

**Active Feedback sensing Technology**

Active Feedback Sensing Technology (AFT) that turns off the motor if the rotation speed suddenly slows down.

**AFT**

**STOP**

**Compact overall length**

For easy handling and control

**182mm**

18V LXT (DHP481 - 205mm)

# Efficient, Durable, Compact, Lightweight and Outstanding Performance Percussion Driver Drill

A powerful, brushless Percussion Driver Drill for screwdriving and drilling with two different power settings for professional use. A high maximum torque of 140 / 68 Nm. An ideal choice for jobs that require high power and torque. Integrated LED light. A combination of innovative tool design and higher output batteries, providing a durable solution for the professional user with high demand



**Work Amount** (on a full battery charge)

**144pcs**

40v max (4.0Ah)

**78pcs**

DHP481 18V LXT (5.0Ah)

**768pcs**

40v max (4.0Ah)

**457pcs**

DHP481 18V LXT (5.0Ah)

Drilled holes through a 38mm SPF plate with ø2-9/16" Self-feed bit in low speed mode.

Drilled holes through a 30mm brick with ø8 mm TCT drill bit in high speed mode.

Specification	
Capacity	Steel: 20 mm / Wood (Auger-Bit): 50 mm Wood (Self-Feed Bit): 76 mm / (Hole Saw): 152 mm Masonry: 20 mm
Chuck Capacity	1.5 - 13 mm
Impacts Per Minute (IPM)	High / Low: 0 - 39,000 / 0 - 9,750
No Load Speed (RPM)	High / Low: 0 - 2,600 / 0 - 650
Max Fastening Torque	Hard / Soft: 140 / 68 N-m
Max lock torque	125 Nm
Sound Pressure Level	85 dB(A)
Sound Power Level	96 dB(A)
Dimensions (L x W x H)	182x86x282 mm
Net weight	3.0 kg

Available Variants				
TYPE	VARIANTS	BATTERIES	CHARGER	MAKPAC CASE
W/O Battery / Charger	HP001G Z	-	-	-
With Battery / Charger	HP001G M2	BL4040 (4.0Ah) 2pcs	DC40RA 1pc	Type 3

# TD001G

## XGT - Cordless Impact Driver

**XGT**  
**40V<sup>max</sup> Li-ion BL MOTOR XPT**



Max. Fastening Torque

**220N.m**  
with powerful  
brushless motor

Twin LED job light

Control panel for selecting  
the right settings from  
multiple operation modes



One-touch bit  
installation,  
rigid anvil holder  
with ball  
bearings reduces  
bit wobbling

## 10 Tightening modes

### Wood mode

driving at low speed until fastening  
begins



0 - 1,800 / 4,400

### 3 Bolt mode

with rotation auto stop for tightening/  
loosening bolts for more efficient work

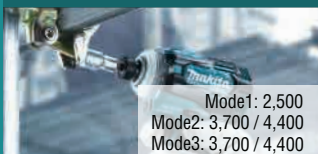

Mode1: 2,500  
Mode2: 3,700 / 4,400  
Mode3: 3,700 / 4,400

### T1 Teks screw (thin metal)

Driving self-drilling screws to a  
thin gauge metal like a metal stud



0 - 2,400

### T2 Teks screw (thick metal)

Driving self-drilling screws to a  
thick gauge metal



0 - 3,700 / 2,600

### Max



0 - 3,700 / 4,400

### Hard

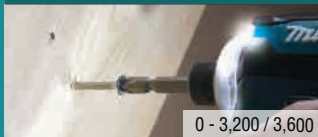

0 - 3,200 / 3,600

### Medium



0 - 2,100 / 2,600

### Soft



0 - 1,100 / 1,100

No load speed / Impacts per min

### One-touch 4-speed selector

Provides precise fastening control for a wide range  
of applications

### Quick-change memory mode

allows operator to rapidly change between two  
registered setting

## Driver drill with multiple modes

TD001G is an efficient and powerful brushless Impact Driver with multiple operation modes. The machine has an excellent ability to perform heavy-duty continuous tightening. Constant speed control maintains fastening torque by preventing the rotation speed reduction caused by decreased battery capacity. This machine is a genuine solution for high demand industrial users.



## Work Amount (on a full battery charge)

**1,280pcs**

40v max (4.0Ah)

**784pcs**

DTD171  
18V LXT (5.0Ah)

Drove 65mm coarse thread screw  
Mode: MAX mode

**752pcs**

40v max (4.0Ah)

**522pcs**

DTD171  
18V LXT (5.0Ah)

Drove 65mm metal fastening screws  
Mode: MAX mode

## Specification

<b>Capacity</b>	Machine Screw: M4 - M8 (5/32" - 5/16") Standard Bolt: M5 - M16 (3/16" - 5/8") High Strength Bolt: M5 - M14 (3/16" - 9/16") Coarse thread : 22 - 125 mm (7/8" - 4-7/8")
<b>Hex Shank</b>	6.35 mm (1/4")
<b>No Load Speed (RPM)</b>	Max / H / M / S: 0 - 3,700 / 3,200 / 2,100 / 1,100
<b>Impacts Per Minute (IPM)</b>	Max / H / M / S: 0 - 4,400 / 3,600 / 2,600 / 1,100
<b>Max Fastening Torque</b>	220 Nm
<b>Fastening Torque</b>	Hard / Med / Soft: 170 / 50 / 20 N-m
<b>Sound Pressure Level</b>	96 dB(A)
<b>Sound Power Level</b>	107 dB(A)
<b>Dimensions (L x W x H)</b>	120x86x250 mm
<b>Net weight</b>	2.0 kg

## Available Variants

TYPE	VARIANTS	BATTERIES	CHARGER	MAKPAC CASE
W/O Battery / Charger	TD001G Z	-	-	-
With Battery / Charger	TD001G M2	BL4040 (4.0Ah) 2pcs	DC40RA 1pc	Type 2

# TW001G

## XGT - Cordless Impact Wrench



Forward and reverse rotation auto stop mode

### High torque with Brushless Motor

Delivers **1800Nm** of Max fastening torque achieved with combination of high power brushless motor and innovative XGT battery  
(Note: DTW1001 - 18V LXT: 1,050Nm)



### Electronic 4-stage impact power selection

Enables user to control the power and speed depending on the applications



### Full Speed Mode

Switches between variable and full speed by pressing the button. Reaches full speed with fewer pull trigger to minimize user's fatigue in continuous work



### Compact overall length

For easy handling and control



# Nut buster Impact Wrench

## with over 2030N.m Torque

TW001G 3/4" Impact Wrench is and powerful and efficient with nut busting torque of 2030Nm. 4 speed setting with automatic stop function when a strike is detected also with reverse stops function. There is also a Power Mode when this is on the trigger only needs to be depressed 1/2 way to achieve full speed, this elevates stress on the operators trigger finger.



### Work Amount (on a full battery charge)

**350pcs**  
40v max (4.0Ah)

XGT

**75pcs**  
DTW1001  
18V LXT (5.0Ah)

LXT

Tightening M27 high strength bolts

Tightening M22 high strength bolts

### Specification

<b>Fastening Capacities</b>	Standard Bolt: M12 - M36
	High Strength Bolt: M10 - M27
<b>Square Drive</b>	19 mm (3/4")
<b>No Load Speed (RPM)</b>	Max /H/M/S: 0 - 1,800 / 0 - 1,400 / 0 - 1,150 / 0 - 950
<b>Impacts Per Minute (IPM)</b>	Max /H/M/S: 0 - 2,500 / 0 - 2,400 / 0 - 2,200 / 0 - 1,900
<b>Max Fastening Torque</b>	1,800 Nm
<b>Dimensions (L x W x H)</b>	217x94x303 mm
<b>Net weight</b>	4.2 kg

### Available Variants

TYPE	VARIANTS	BATTERIES	CHARGER	MAKPAC CASE
W/O Battery / Charger	TW001G Z	-	-	-
With Battery / Charger	TW001G M2	BL4040 (4.0Ah) 2pcs	DC40RA 1pc	Type 3

# HR003G

## XGT - Cordless Combination Hammer 28mm

[Adapted for SDS-PLUS bit]

**XGT**

**40V**  
max

**Li-ion**  
MOTOR

**BL**

**AVT**

**XPT**

Impact Energy  
**3.2J**

3 Mode Operation

Twin LED joblight

### AVT Anti Vibration Technology

Anti vibration grip

Counterweight mechanism

Vibration absorbing handle

HEPA filter

Vibration Level  
**7.0m/s<sup>2</sup>**

### Good Tool Balance for Increased Operability

The tool's center of gravity is located as close to the handle grip as possible, providing more control and less fatigue



### Dust extraction System (Optional)

The Dust Extractor Attachment with HEPA Filter to capture concrete dust during drilling

Overall length: : 260mm

(Model DX14 Part # 191E52-3)

## Excellent drilling performance

## Extremely compact & lightweight

Powerful combination hammer with AVT vibration damping technology for SDS-Plus bits. High 40V max voltage. Drilling with or without impact and chipping. The speed range is 0-980 min-1. The impact force is 3.2J and the maximum capacity for concrete is 28 mm.



### Work Amount (on a full battery charge)



Drilled holes a depth of 60mm in concrete with ø10.5mm bit

### Specification

Impact Energy	3.2 J
Capacity	Concrete 28 / Steel 13 / Wood 32 / Core Bit 54 / Diamond Core Bit (Dry Type) 65 mm
Blows Per Minute (BPM)	0 - 5,000
No Load Speed (RPM)	0 - 980
Chuck Capacity	1.5 - 13 mm
Sound Pressure Level	95 dB(A)
Sound Power Level	106 dB(A)
Dimensions (L x W x H)	373x102x238 mm
Net weight	4.6 kg

### Available Variants

TYPE	VARIANTS	BATTERIES	CHARGER	MAKPAC CASE
W/O Battery / Charger	HR003G Z	-	-	-
With Battery / Charger	HR003G M2	BL4040 (4.0Ah) 2pcs	DC40RA 1pc	Type 4

# HR002G

XGT - Cordless Combination Hammer 28mm  
[Adapted for SDS-PLUS bit]

**XGT** **40V** **max** **Li-ion** **MOTOR** **BL** **AFT** **AWS** **AVT** **SOFT** **NOLOAD** **XPT**



## AVT Anti Vibration Technology



## Active Feedback sensing Technology

**Smart function to minimize the danger of kick-back**

Shuts down the tool if the rotation speed suddenly slows down



## Good Tool Balance for Increased Operability

The tool's center of gravity is located as close to the handle grip as possible, providing more control and less fatigue

## AWS Auto-start Wireless System

Connects to compatible Dust Extractor with Bluetooth. Dust extractor starts automatically when the tool starts. Also dust extractor stops on its own when the tool is in rest



Bluetooth Chip (Optional)  
Part #: 198900-7

## Dust extraction System (Optional)

The Dust Extractor Attachment with HEPA Filter to capture concrete dust during drilling

Overall length: 260mm

(Model DX12  
Part # 191E58-1)



## Excellent drilling performance Extremely compact & lightweight

Powerful combination hammer with AVT vibration damping technology for SDS-Plus bits. High 40V max voltage. Drilling with or without impact and chipping. The speed range is 0-980 min-1. The impact force is 3.2J and the maximum capacity for concrete is 28 mm.



## Work Amount (on a full battery charge)

**138pcs**

40v max (4.0Ah)

XGT

**106pcs**

DHR283  
18V+18V LXT (3.0Ah)

LXT

Drilled holes a depth of 60mm in concrete with ø10.5mm bit

## Specification

Impact Energy	3.2 J
Capacity	Concrete 28 / Steel 13 / Wood 32 / Core Bit 54 / Diamond Core Bit (Dry Type) 65 mm
Blows Per Minute (BPM)	0 - 5,000
No Load Speed (RPM)	0 - 980
Chuck Capacity	1.5 - 13 mm
Sound Pressure Level	93 dB(A)
Sound Power Level	104 dB(A)
Dimensions (L x W x H)	404x102x238 mm
Net weight	4.6 kg

## Available Variants

	VARIANTS	BATTERIES	CHARGER	BLUETOOTH CHIP	MAKPAC CASE
W/O Battery / Charger	HR002G Z	-	-	-	-
With Battery / Charger	HR002G M2	BL4040 (4.0Ah) 2pcs	DC40RA 1pc	-	Type 4

# GA004G / GA005G

XGT - Cordless 115mm / 125mm  
Slide Switch - Angle Grinders



## High durability with BL motor

- Large ball bearing supports the motor.
- New switch design to reduce contact weariness

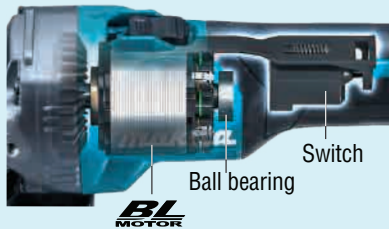

## New tool-less wheel cover

- Allows for fast and easy angle adjustment and installation / removal of wheel cover

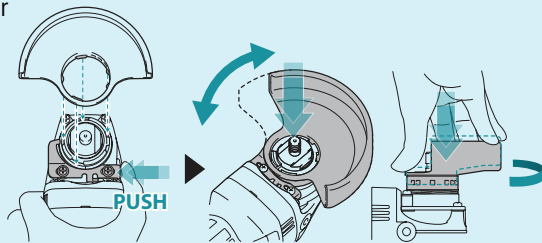

## Active Feedback sensing Technology

- Shuts down the tool, if the rotation speed suddenly slows down

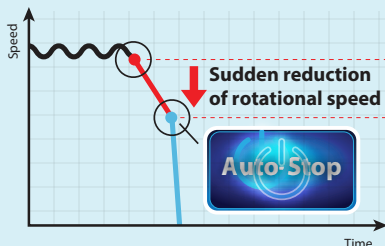

## Dust wheel guard (optional)

Wheel guard connects to dust extractors for 115mm/125mm

- 191F81-2  
For Cup Wheel



- 191G06-2  
For Diamond Wheel



# Excellent in continuous heavy-duty work Slide Switch Angle Grinders

A high durability slide switch angle grinders which delivers same power as 1000W corded grinders for demanding professional. These machines features standard electronics, overload protection and AFT-active feedback detection technology. Extreme Protection Technology protects the machine in outdoor applications or harsh environments.



## Work Amount (on a full battery charge)

12cuts

40v max (4.0Ah)

XGT

5cuts

DGA454

18V LXT (5.0Ah)

LXT

Cut concrete continuously at a depth of 20mm and measured the time required to cut a 600mm wide concrete plate

Specification	GA004G	GA005G
Wheel Diameter	115 mm	125 mm
Hole Diameter	22.23 mm	22.23 mm
No Load Speed (RPM)	8,500	8,500
Sound Pressure Level	81 dB(A)	81 dB(A)
Sound Power Level	92 dB(A)	92 dB(A)
Dimensions (L x W x H)	410x130x168 mm	410x140x168 mm
Net weight	3.5 kg	3.6 kg

## Available Variants

TYPE	VARIANTS	BATTERIES	CHARGER	MAKPAC CASE
W/O Battery / Charger	GA004G Z	-	-	-
	GA005G Z	-	-	-
With Battery / Charger	GA004G M2	BL4040 (4.0Ah) 2pcs	DC40RA 1pc	Type 4
	GA005G M2	BL4040 (4.0Ah) 2pcs	DC40RA 1pc	Type 4

# GA012G / GA013G

XGT - Cordless 115mm / 125mm  
Paddle Switch - Angle Grinders



## High durability with BL motor

- Large ball bearing supports the motor.
- New switch design to reduce contact weariness

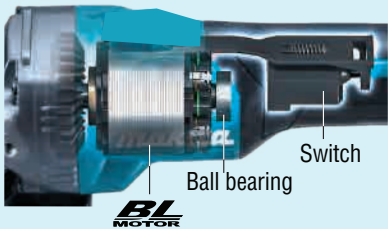

## New toolless wheel cover

- Allows for fast and easy angle adjustment and installation / removal of wheel cover

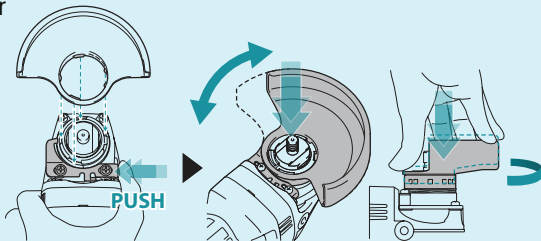

## Active Feedback sensing Technology

- Shuts down the tool, if the rotation speed suddenly slows down

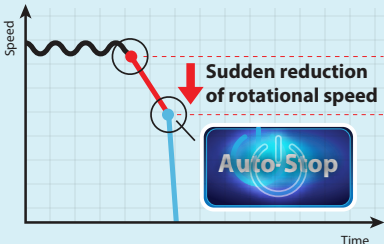

## Dust wheel guard (optional)

Wheel guard connects to dust extractors for 115mm/125mm

- 191F81-2  
For Cup Wheel



- 191G06-2  
For Diamond Wheel



# Excellent in continuous heavy-duty work Paddle Switch Angle Grinders

A high durability paddle switch angle grinders which delivers same power as 1000W corded grinders for demanding professional. These machines features standard electronics, overload protection and AFT-active feedback detection technology. Extreme Protection Technology protects the machine in outdoor applications or harsh environments.



## Work Amount (on a full battery charge)

12cuts

40v max (4.0Ah)

XGT

5cuts

DGA454

18V LXT (5.0Ah)

LXT

Cut concrete continuously at a depth of 20mm and measured the time required to cut a 600mm wide concrete plate

Specification	GA012G	GA013G
Wheel Diameter	115 mm	125 mm
Hole Diameter	22.23 mm	22.23 mm
No Load Speed (RPM)	8,500	8,500
Sound Pressure Level	81 dB(A)	81 dB(A)
Sound Power Level	92 dB(A)	92 dB(A)
Dimensions (L x W x H)	410x130x168 mm	410x140x168 mm
Net weight	3.5 kg	3.6 kg

## Available Variants

TYPE	VARIANTS	BATTERIES	CHARGER	MAKPAC CASE
W/O Battery / Charger	GA012G Z	-	-	-
	GA013G Z	-	-	-
With Battery / Charger	GA012G M2	BL4040 (4.0Ah) 2pcs	DC40RA 1pc	Type 4
	GA013G M2	BL4040 (4.0Ah) 2pcs	DC40RA 1pc	Type 4

# HS004G

## XGT - Cordless 190 / 185 mm Circular Saw



### ADT Automatic Torque Drive Technology

Automatically changes the cutting speed according to load conditions for an optimum operations

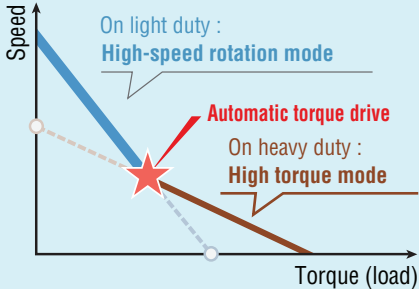

### Overload alert using ADT indicator lamp



Blinks green to indicate that the tool is overloaded

### Compatible with guide rail without adapter



### Maximum bevel capacity



### Blower function



### AWS Auto-start Wireless System

Connects to compatible Dust Extractor with Bluetooth. Dust extractor starts automatically when the tool starts. Also dust extractor stops on its own when the tool is in rest



Switch on the tool Dust Extractor is activated

Bluetooth Chip  
Part # : 198900-7



# Excellent balance and High power machine

An efficient brushless 40Vmax XGT Li-Ion circular saw with excellent balance, high power and lightweight maneuverability similar to corded tools.



### Work Amount (on a full battery charge)

145pcs  
40v max (4.0Ah)

120pcs  
DHS783  
18V+18V LXT (3.0Ah)

Melapi (thickness=60mm / width=300mm)

### Specification

Blade Diameter	190 / 185 mm
Max Cutting Capacity	90°: 62.5 / 60 mm 45°: 44.5 / 43 mm 48°: 42 / 41 mm
No Load Speed (RPM)	6,000
Dimensions (L x W x H)	337x210x290 mm
Net weight	4.7 kg

### Available Variants

TYPE	VARIANTS	BATTERIES	CHARGER	BLUETOOTH CHIP	MAKPAC CASE
W/O Battery / Charger	HS004G Z	-	-	1pc	-
With Battery / Charger	HS004G M1	BL4040 (4.0Ah) 1pc	DC40RA 1pc	1pc	Type 4

# JR001G

## XGT - Cordless Reciprocating saw

**XGT**  
**40V** **Li-ion** **max** **BL** **MOTOR** **XPT**

### Effective Lubricating mechanism of slide switch

### Rigid Shoe

- Shoe has been reinforced.
- Fixed type shoe is used for added durability

### Rubber Joint Structure

The tool body is separated into the upper and lower housings which joined with vibration absorbing cushion rubbers to reduce load on battery and terminal

### High Power and lightweight

Higher power delivered by the BL motor designed to best suit XGT battery. Lightweight achieved by employing one XGT battery drive but with High power

### Smooth cutting with vertical crank system

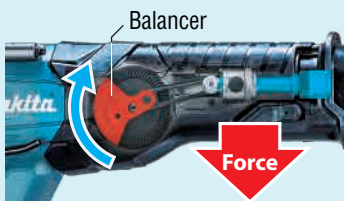

The crank mechanism has been designed to rotate vertically to provides less vibration to the user

### Tool-less shoe adjustment

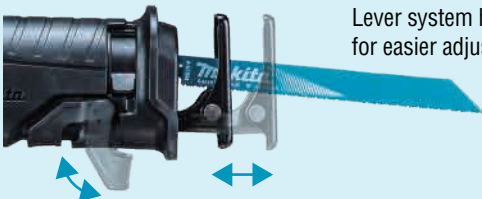

Lever system has been designed for easier adjustment

### Easy blade ejection lever



Simply insert the blade for installation. Removal can be done with single action no need to touch the blade. A great feature when working with hot blades.

## Lightweight, Powerful, Durable and Built to perform

An efficient brushless reciprocating saw for spark-free cutting of metal and demolition work for professional use. Possibility to choose two different speed settings, stroke length of 32 mm and stroke rate of 0-3 000 min-1 with continuous control from the switch. Saw is also equipped with quick-release blade attachment for fast and effortless blade change.



### Work Amount (on a full battery charge)

**130pcs**

40v max (4.0Ah)

XGT

**87pcs**

DJR360  
18V+18VLXT (3.0Ah)

LXT

ø25.4mm (1") Carbon steel pipe

**155pcs**

40v max (4.0Ah)

XGT

**103pcs**

DJR360  
18V+18VLXT (3.0Ah)

LXT

SPF 2 x 10

### Specification

Length of Stroke	32 mm
Strokes Per Minute (SPM)	High / Low: 0 - 3,000 / 0 - 2,300
Capacity	Pipe : 130 mm / Wood: 255 mm
Sound Pressure Level	85 dB(A)
Sound Power Level	96 dB(A)
Dimensions (L x W x H)	472x88x239 mm
Net weight	4.5kg

### Available Variants

TYPE	VARIANTS	BATTERIES	CHARGER	CARRY CASE
W/O Battery / Charger	JR001G Z	-	-	-
With Battery / Charger	JR001G M2	BL4040 (4.0Ah) 2pcs	DC40RA 1pc	Plastic Case

# 40Vmax Lithium-ion Battery Series

